

# H I S A R

## FINAL DEVELOPMENT PLAN FOR THE CONTROLLED AREAS 2021 A.D.

(COUNTER MAGNET TOWN HISAR)

### LEGEND

- ADDITIONAL CONTROLLED AREA BOUNDARY-II
- CONTROLLED AREA BOUNDARY.
- ADDITIONAL CONTROLLED AREA BOUNDARY-I
- MUNICIPAL BOUNDARY NEW
- C.C.S. HARYANA AGRICULTURAL UNIVERSITY BOUNDARY
- CONTONMENT BOUNDARY
- RAILWAY BROAD GAUGE/METER GAUGE
- ROAD EXISTING.
- DISTRIBUTARY/MINOR
- VILLAGES

### MAIN SUB. CODE CODE PROPOSED LAND USE:-

- 100 RESIDENTIAL**
- 200 COMMERCIAL**
  - 210 RETAIL TRADE.
  - 220 WHOLESALE TRADE
  - 230 WARE-HOUSING AND STORAGE.
  - 240 OFFICE & BANKS INCLUDING GOVT. OFFICES.
- 300 INDUSTRIAL**
  - 320 LIGHT INDUSTRY.
  - 330 EXTENSIVE /MEDIUM INDUSTRY EXISTING INDUSTRY
- 400 TRANSPORT & COMMUNICATION**
  - 410 RAILWAY YARDS ,RAILWAY STATION & SINDINGS
  - 420 ROADS,ROAD TRANSPORT DEPOTS & PARKING AREAS
  - 440 AIR STATIONS / AIR PORT
- 500 PUBLIC UTILITIES**
  - 510 WATER SUPPLY INSTALLATIONS.
  - 520 DRAINAGE & SANITARY INSTALLATION , DISPOSAL WORKS. INCULDING TREATMENT PLANT.
  - 530 ELECTRIC POWER PLANTS, SUB STATION ETC.
- 600 PUBLIC & SEMI PUBLIC USES**
  - 610 GOVT. ADMINISTRATIVE CENTRAL SECRETARIAT DISTT. OFFICES, LAW COURTS ,JAILS, POLICE STATION ( GOVERNERS & PRESIDENT RESI.)
  - 620 EDUCATIONAL, CULTURAL,RELIGIOUS INSTITUTIONS
  - 630 MEDICAL AND HEALTH INSTITUTIONS.
  - 640 CULTURAL INSTITUTIONS LINK THEATRES,OPERA HOUSES ETC. PREDOMINANTLY NON COMMERCIAL ( NATURE )
  - 650 LAND BELONGING TO DEFENCES
- 700 OPEN SPACES**
  - 720 PARKS.
  - 730 GREEN BELT, GARDEN & RECREATIONAL USES.
- 800 AGRICULTURAL LAND**
- SPECIAL ZONE**
- SECTOR NO.**
- POPULATION DENSITY (NET)**
- CODE NO.**

NOTE:- THIS DRAWING SUPERSEDES PREVIOUS DRAWING NO. D.T.P.(H)3398/2005 DATED 22-4-2005.

NOTE:- THE FINAL DEVELOPMENT PLAN HISAR HAS BEEN PUBLISHED IN HARYANA GOVT. GAZETTE DATE 9-02-2007.

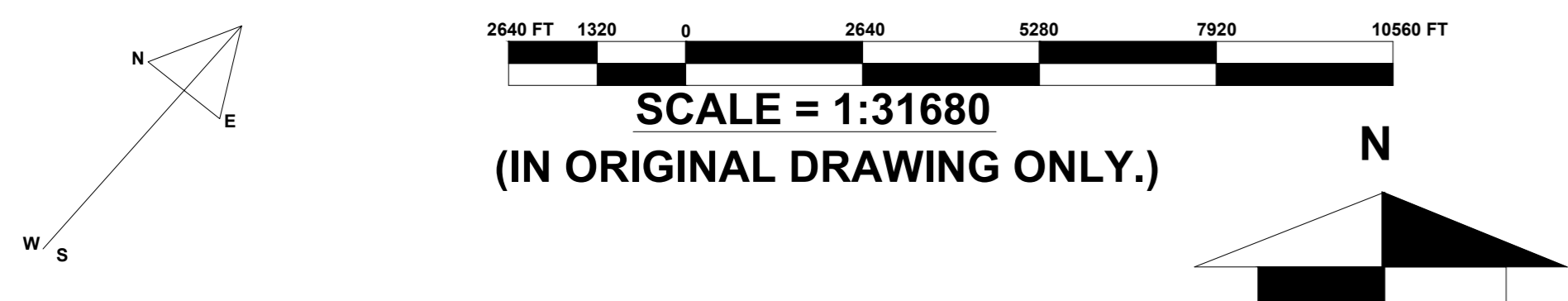

DRG. NO. D.T.P. (H) 3416/2006 DT. 26-10-2006.

DRAWN BY:- SD/- (Fakir Chand A.D.) CHECKED BY:- SD/- (Sammat Singh J.D.)  
 PLANNING ASSTT. SD/- (Mahender Singh)  
 ASSTT. TOWN PLANNER ( VACANT )  
 DISTT. TOWN PLANNER SD/- (S.S. Chauhan) SD/- (S. Saini)  
 SENIOR TOWN PLANNER SD/- (K.K. Yadav) CHIEF CO-ORDINATOR PLANNER,  
 HISAR CIRCLE HISAR N.C.R HARYANA ,PANCHKULA

DEPTT. OF TOWN & COUNTRY PLANNING HARYANA.

### LEGEND

- TOTAL AREA OF AIRPORT = 1541.41 HECT.
- AREA UNDER RESIDENTIAL = 320.72 HECT.
- AREA UNDER PUBLIC & SEMI-PUBLIC = 58.25 HECT.
- AREA UNDER COMMERCIAL = 124.82 HECT.
- AREA UNDER PARK, GREEN BELTS & ROADS = 110.09 HECT.
- AREA UNDER PUBLIC UTILITIES = 6.76 HECT.
- AREA UNDER SPECIAL ZONE = 430.27 HECT.
- AREA UNDER EXISTING AIRPORT / TRANSPORT = 279.34 HECT.
- AREA UNDER EXISTING POLICE LINE = 47.46 HECT.
- AREA UNDER EXISTING LAKE = 63.69 HECT.
- AREA UNDER EXISTING BOTTLING PLANT = 3.77 HECT.
- AREA UNDER EXISTING VACCINE INSTITUTE = 62.66 HECT.
- AREA UNDER EXISTING COLLEGE = 33.58 HECT.

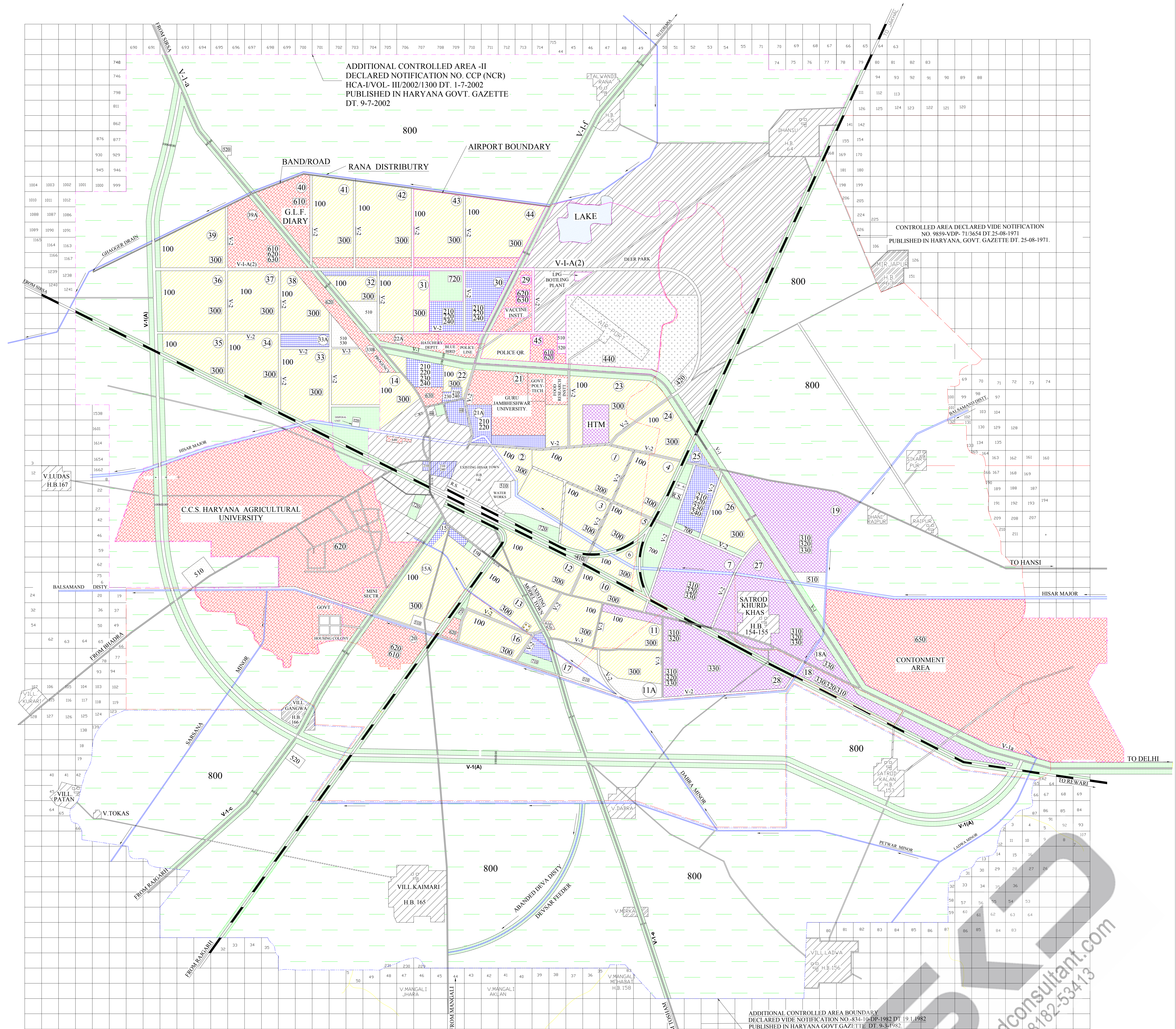

SD/- (S.S. Dhillon)  
 DIRECTOR  
 TOWN & COUNTRY PLANNING  
 HARYANA,CHANDIGARH

NOTE: This copy is a digitised copy of the original Development Plan notified in the Gazette. Though precaution has been taken to make it error free, however minor errors in the same cannot be completely ruled out. Users are accordingly advised to cross-check the scanned copies of the notified Development plans hosted on the website for all practical purposes. Director Town and Country Planning, Haryana and / or its employees will not be liable under any condition for any legal action/damages direct or indirect arising from the use of this development plan. The user is requested to convey any discrepancy observed in the data to Sh. Dharm Rana, GIS Developer (IT), mail id- dev.drt.t@gmail.com, mob. no. 98728-77583.